

## IMPROVEMENTS OF THE FREEWHEEL



Black hub = new version



Chrome hub = old version

### Improvements of the Freewheel

The producer of Freewheel has introduced a number of improvements of the product, as described below. All units that leaves Panthera today has these improvements. The easiest way to decide whether you have the new version or the old is to check the colour of the hub. If the hub is black it is the new version and if it is chrome it is the old.

### Four improvements of the new version of Freewheel

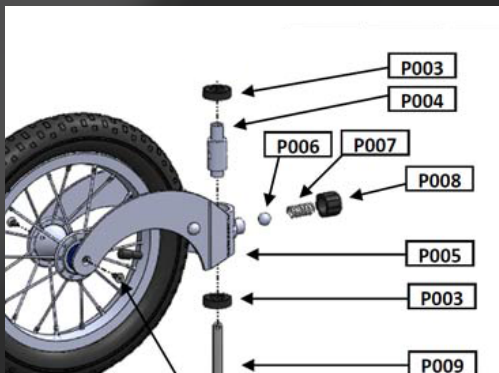

1) Stronger plastic knob (P008)  
Old material was Delrin, new material is glass-filled nylon. It's much tougher now and won't break when abused.

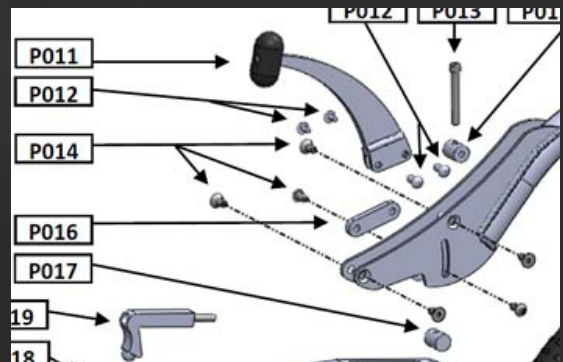

2) All screws with blue Loctite  
This includes screws ( P0104, A, B & C in the manual ) on both sides of the FreeWheel.

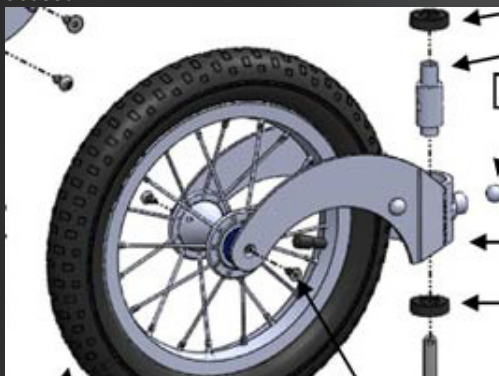

3) Updated wheel  
This includes new axle design, new sealed bearings, new alloy hub and stainless steel spokes. These features make for much easier maintenance as well as improved corrosion resistance. Less rolling resistance and longer lifespan.

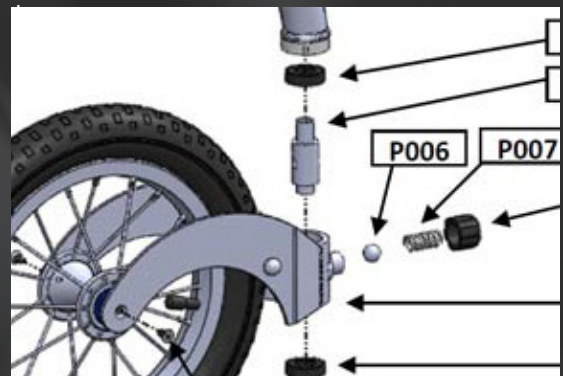

4) Higher standard of ball bearing  
The upgraded FreeWheel have a higher standard of ball bearing ( P006 ).