

Instructions for assembly high break new

Assembly instructions for the new high brake:

1. When you receive the high brake it will be assembled as shown in figure 1.

2. To assemble the brake on your wheelchair, loosen the bolt on the inside of the brake slightly (10) (figure 2), so that you can place the brake clamps (3 and 4) around the seat tubing of the chair.

NB! The bolt which adjusts the brake is situated on the inside of the brake on earlier brake models from Panthera.

3. Then tighten the bolt (10), and move the brake lever (1) forward to put on the brake. The brake should be adjusted so that, in contact position, it bites into the tyre 4-5mm.

- If the brake seems too loose, pull back the brake lever, loosen the bolt (10) and move the brake back slightly. Tighten the bolt and check that the brake is satisfactory.

- If the brake seems too tight, loosen the bolt (10) and move the brake forward slightly. Tighten the bolt and check that the brake is satisfactory.

4. Ensure that the locking edge (2) is positioned straight against the rear wheel to achieve the best possible braking impact.

5. Repeat this procedure on the other side.

NB! If the tyre pressure falls and you adjust the brake with the adjustment ring, make sure the brake still functions by not forgetting to unscrew the adjustment ring when you pump more pressure into the tyre so that the brake does not cut too deeply into the tyre.

Assemble the brake as follows (see figure 2):

1. Pull the adjustment ring (6) into the locking arm (3), then attach the wire (5) in the adjustment ring (6).

2. After that, thread the wire protection (17), with the arched tongue outwards facing the cylinder, into the other end of the wire as shown in figure 3. Push the wire protection securely into the hole on the locking arm. Ensure that the wire protection remains securely in place when you attach the end screw (13). Make sure that the tongue of the wire protection follows the wire when pulled into release brake position.

3. Screw the bolt (11) through the bushing (7), the locking arm (2), the spring (9) and the washer (14) into the outer clamp in the locking arm (3). Use Loctite 2701 on the hinge in the outer clamp (3). NB! The hinge should be sprayed with Loctite Activator 7649 before Loctite 2701 is used.

4. Assemble the handle (1) with the outer clamp (3) using the bushing (8). Use Loctite 2701 on the hinge in the outer clamp (3). Place the sticker (18) over the hole for the Allan key.

NB! The hinge should be sprayed with Loctite Activator 7649 before Loctite 2701 is used.

5. Then attach the wire (5) into the handle (1) using the end washer (14) and the screw (12). Tighten the screw as far as it will go but not too hard since this will damage the plastic hinge.

6. Attach the inner clamp (4) into the outer clamp (3) with the washer (15) and bolt (16).

7. Finally, spray lubricant on both bushings. Make sure the wire is adjusted to the correct length by first unscrewing the wire to its full extent and then turning the adjustment ring three turns so that the wire is at the correct length.

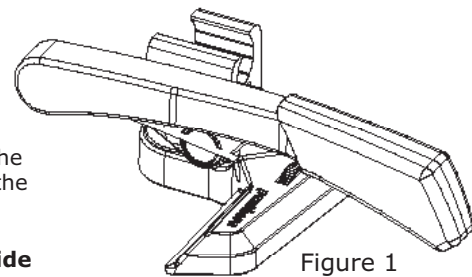

Figure 1

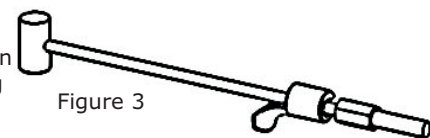

Figure 3

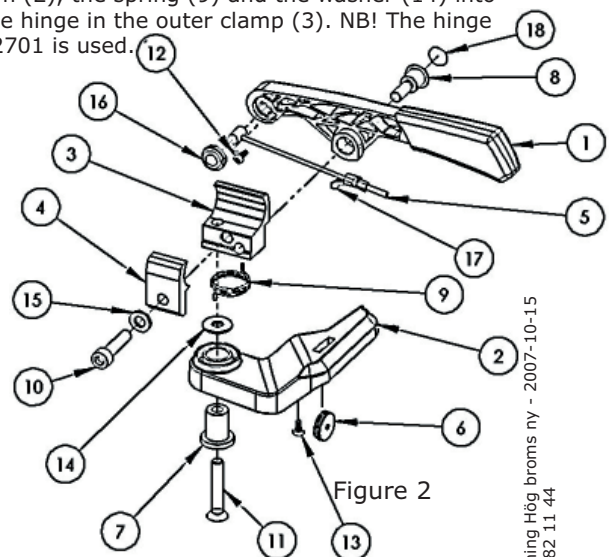

Figure 2