

### REAR AXLE CARBON 6°

Assembly instruction for: Rear axle Carbon 6°

Rear axle Carbon 6°

art.no. 3303024, 3303027, 3303030, 3303033

Rear axle Carbon 6° + 10

art.no. 3303124, 3303127, 3303130, 3303133

Tools needed

4 mm allen key.

Ruler

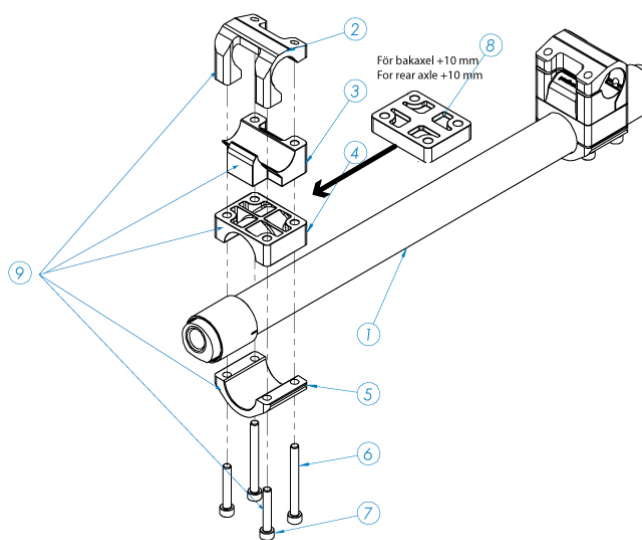

Exploded view for rear axle Carbon 6°

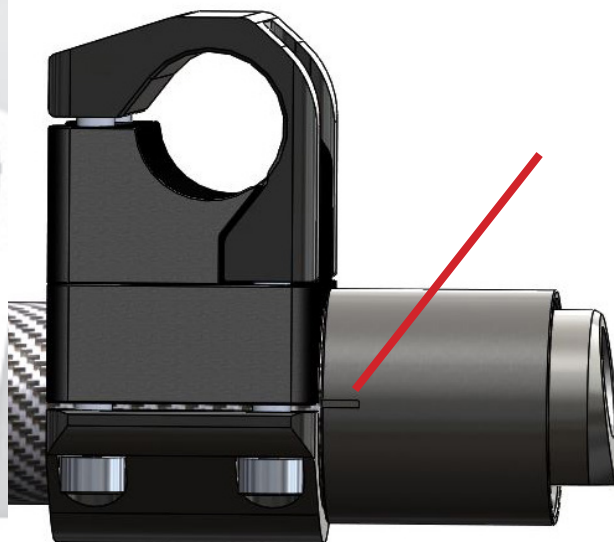

Carved making



**1)** Turn the wheelchair upside down. Star mounting part 3, in the exploded view, on the chassis. Note how the part is positioned, with the long "legs" facing out from the chassis.



**2)** Then place part 4 on the part 3



**3)** Place part 5, upper axle clamp, over part 4.



**4)** Place the axle, 1 in exploded view, on the upper axle clamp 5. **NOTE** that the carved mark faces the front of the wheelchair and the flat part on the axle end faces towards the bottom of the wheelchair.



**5)** Place part 2, the bottom clamp, on the axle.



**6)** Mount the screws through the parts. The two long screws should be on the "inside" of the chassis and the two short on the "outside"



**8)** Tighten the screw slightly, a few turns, with allen key 4 mm.



**9)** Continue to mount the attachment on the other side, done in the same way (steps 1-8).



**10)** Rotate the axle so that the carved marking aligns with edge of the upper clamp. (See picture Carved Marking)



**11)** Adjust the rear axle settings to the desired measure, on both sides.

Standard is:  
S3 short ABD - 31 mm  
Bambino 3 - 77 mm  
Bambino 3 short - 87 mm



**12)** Finally tighten the 8 screws firmly with 5,7 nM.